



THE TOLL HOUSE, LOOE MILLS, LISKEARD, CORNWALL

Carter Jonas

THE TOLL HOUSE, LOOE MILLS

A Grade II listed 3 bedroom detached house constructed of stone beneath a slate roof. The property was constructed in 1837 and retains many delightful features.

The property comprises of 2 reception rooms, a kitchen and 3 bedrooms along with a bathroom.

Externally there is a garden to the rear. Parking is on the road outside.

The Toll House is located to the north of the A38 and to the west of Liskeard in an area known as Looe Mills.

It is within close proximity to the A38. It is conveniently located for access to the Cornish road network.

TENURE Freehold

LOCAL AUTHORITY Cornwall Council

COUNCIL TAX C

EPC BAND Exempt due to Listed Status

A CHARACTER 3 BEDROOM DETACHED GRADE II LISTED COTTAGE CLOSE TO LISKEARD





Approximate Gross Internal Area 1123 sq ft - 104 sq m

Ground Floor Area 558 sq ft – 52 sq m

First Floor Area 565 sq ft – 52 sq m

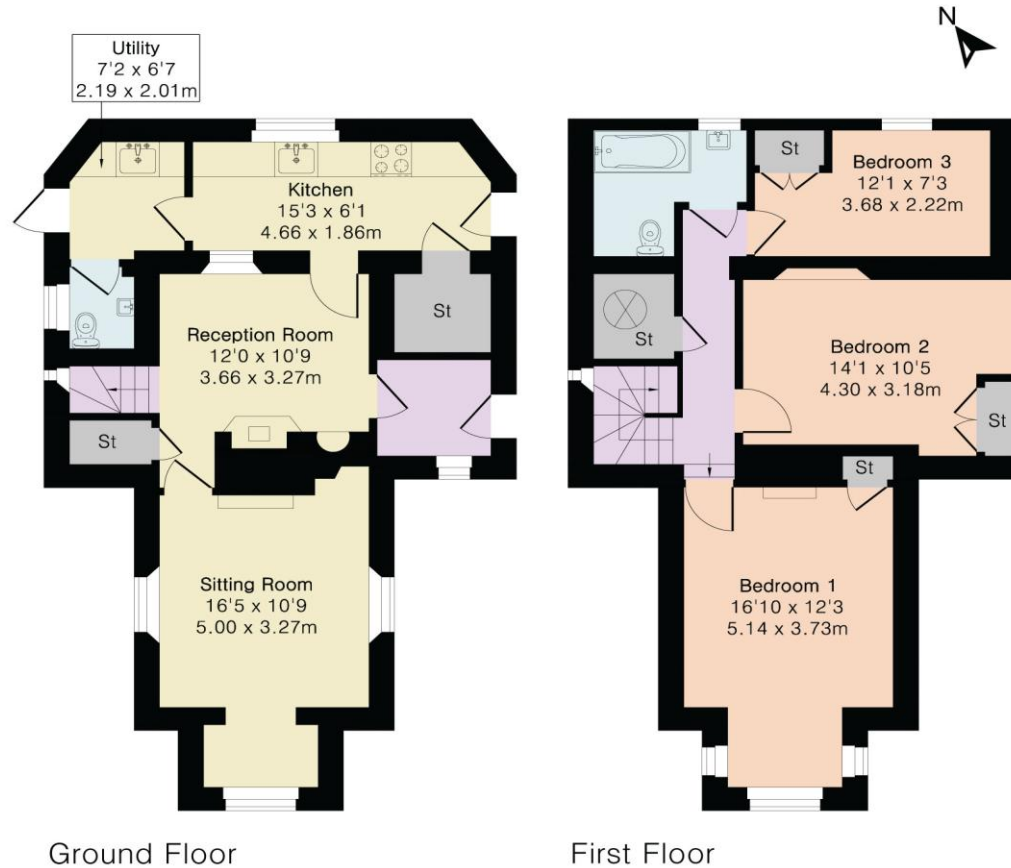

Ground Floor

First Floor

Infrastructures

John.sawdon@carterjonas.co.uk
81 Colmore Row, Birmingham B3 2AP

carterjonas.co.uk
Offices throughout the UK

IMPORTANT INFORMATION

These particulars are for general information purposes only and do not represent an offer of contract or part of one. Carter Jonas has made every attempt to ensure that the particulars and other information provided are as accurate as possible and are not intended to amount to advice on which you should rely as being factually accurate. You should not assume that the property has all necessary planning, building regulations or other consents and Carter Jonas have not tested any services, facilities or equipment. Any measurements and distances given are approximate only. Purchasers must satisfy themselves of all of the aforementioned by independent inspection or otherwise. Although we make reasonable efforts to update our information, neither Carter Jonas LLP nor anyone in its employment or acting on its behalf makes any representations warranties or guarantees, whether express or implied, in relation to the property, or that the content in these particulars is accurate, complete or up to date. Our images only represent part of the property as it appeared at the time they were taken. If you require further information please contact us.