



POOL MEADOW CLOSE, SOLIHULL B91

Carter Jonas

POOL MEADOW CLOSE, SOLIHULL

The Property comprises a five-bedroom detached bungalow, with 2 reception rooms, kitchen and 2 bathrooms.

There is a good sized rear garden with space to the front of the Property, with off road parking. Attached to the property is a large single garage.

The property is in need of refurbishment and there is potential to extend the subject to planning.

The property occupies a large plot.

It is located in a popular residential area close to Solihull and within a short distance of the M42 and Birmingham International Airport. The Midlands Railway network is also easily accessible with both Solihull and Widney Manor within a short drive and Birmingham International accessed from the M42.

A 5 BEDROOM DETACHED BUNGALOW OCCUPYING A LARGE PLOT AND REQUIRING REFURBISHMENT



TENURE Freehold

LOCAL AUTHORITY Solihull BC

COUNCIL TAX G

EPC BAND G





Approximate Gross Internal Area 2188 sq ft - 203 sq m
(Including Garage)

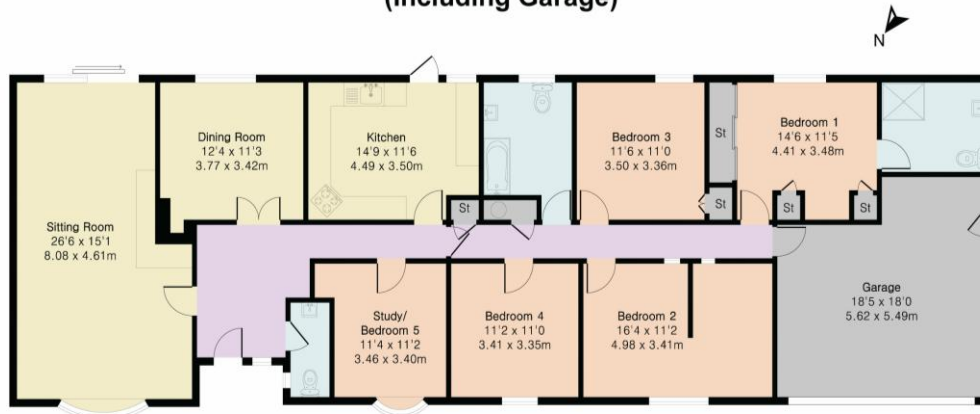

Infrastructures

John.sawdon@carterjonas.co.uk
81 Colmore Row, Birmingham B3 2AP

carterjonas.co.uk
Offices throughout the UK

IMPORTANT INFORMATION

These particulars are for general information purposes only and do not represent an offer of contract or part of one. Carter Jonas has made every attempt to ensure that the particulars and other information provided are as accurate as possible and are not intended to amount to advice on which you should rely as being factually accurate. You should not assume that the property has all necessary planning, building regulations or other consents and Carter Jonas have not tested any services, facilities or equipment. Any measurements and distances given are approximate only. Purchasers must satisfy themselves of all of the aforementioned by independent inspection or otherwise. Although we make reasonable efforts to update our information, neither Carter Jonas LLP nor anyone in its employment or acting on its behalf makes any representations warranties or guarantees, whether express or implied, in relation to the property, or that the content in these particulars is accurate, complete or up to date. Our images only represent part of the property as it appeared at the time they were taken. If you require further information please contact us.