



CHANTRY HOUSE, RIPLEY, HARROGATE, NORTH YORKSHIRE, HG3 3AY
£4,500 per month

Carter Jonas

CHANTRY HOUSE, RIPLEY, HARROGATE, NORTH YORKSHIRE, HG3 3AY

- Available Now
- Gas Fired Central Heating
- EPC Rating E
- Council Tax Band G
- Beautiful Village Location

THE PROPERTY

Nestled within the idyllic village of Ripley, Chantry House is a stunning Grade II listed property which boasts character and occupies a prominent position only a stone throws away from the renowned Ripley Castle. Located 4 miles north of the spa town of Harrogate, this delightful family home offers a wealth of character and dates back to the mid-18th Century.

Chantry House holds a unique charm offering impressive and expansive living accommodation arranged over three floors, making this property perfect for family living.

In brief the ground floor comprises a spacious sitting room with large windows boasting natural light and a log burning stove, a separate dining room positioned off the hallway benefitting from a log burning stove with a useful WC conveniently positioned nearby.

The open plan breakfast kitchen offers a selection of fully fitted units with beautiful white quartz work surfaces, a free-standing electric Rangemaster cooker, integrated dishwasher and fridge-freezer. There is a separate utility room off the kitchen which comprises a selection of units with ceramic sink and appliances including a washing machine and dryer.

The original Victorian conservatory has been painstakingly restored back to its former glory by the current owners and provides a characterful link through to an extensive ballroom which was added to Chantry House at the end of the Victorian era and comprises a variety of period features including two feature fireplaces with log burning stoves, beautiful sky lights and bespoke chandeliers.

Four spacious double bedrooms are situated on the first floor; the primary bedroom provides plenty of space with views towards All Saints Church and benefits from a charming Jack and Jill bathroom with a modern suite and rainfall shower. There are three further double bedrooms one of which has a modern shower suite and separate WC nearby, with two further double bedrooms located on the second floor.

Nestled within the idyllic village of Ripley, Chantry House is a stunning Grade II listed property which boasts character and occupies a prominent position only a stone throws away from the renowned Ripley Castle.



Externally, there are double gates to the side of the house which provide access to secure parking via the gravelled driveway and lead to a spacious double garage with electricity and water supply.

There are beautiful walled gardens to the rear of which provide established borders, a well-proportioned patio area with further stone-built stores adjoining the house for additional storage.

The picturesque village of Ripley offers an array of amenities including a village store and ice cream shop, butchers, town hall which frequently hosts a selection of events, the Boars Head Hotel and Restaurant, Castle Tearoom, Grindhus Coffee Shop, Ripley Castle and the renowned gardens and All Saints Church which provides weekly services.

A bus service operates throughout the day to the nearby towns of Harrogate, Ripon and Leeds via Harrogate. For the commuter, the property is well situated close to the A61, which provides good connections to the A1(M), A59 and further afield.

There are high performing schools only a short distance away including Harrogate Grammar School and Ripon Grammar School with Ripley Endowed Church of England Primary School within walking distance.

The property is offered to let on a 12 Month Assured Shorthold Tenancy.

Chantry House is connected to mains water, gas and electricity, and is heated via a gas fired central heating system, with two log burning stoves situated in the living room and dining room as an additional heat source.

The deposit will be £5,192 (5 week's rent) at a rental value of £4,500 per calendar month.

The holding deposit will be £1,038 (1 week's rent) at a rental value of £4,500 per calendar month.



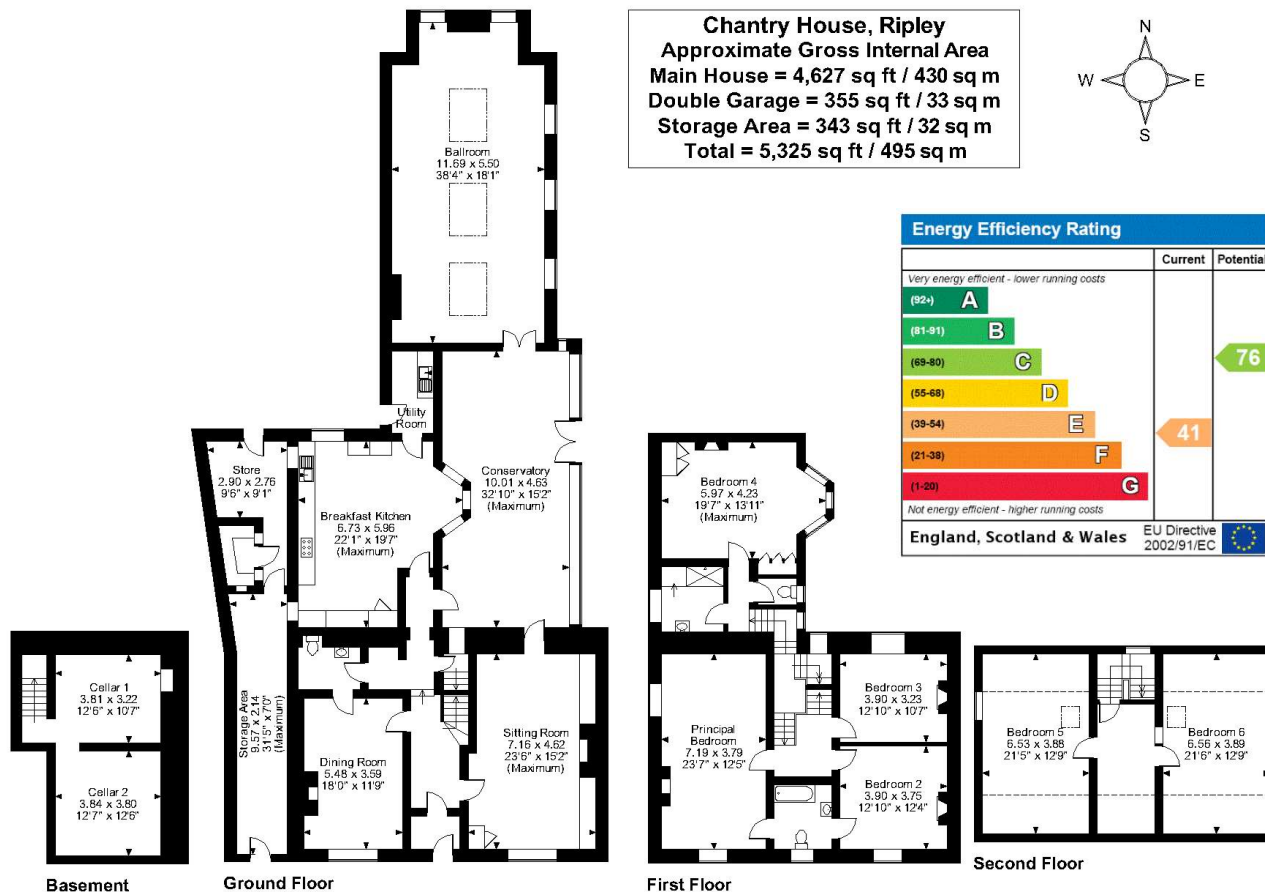

FOR ILLUSTRATIVE PURPOSES ONLY - NOT TO SCALE

The position & size of doors, windows, appliances and other features are approximate only.

□ □ □ □ Denotes restricted head height

© ehous. Unauthorised reproduction prohibited. Drawing ref. dig/8526775/SS



T: 01423 523423

Regent House, 13-15 Albert Street, Harrogate, HG1 1JX

E: harrogate.rural@carterjonas.co.uk



Exclusive UK affiliate of

CHRISTIE'S
INTERNATIONAL REAL ESTATE

Classification L2 - Business Data

IMPORTANT INFORMATION

These particulars are for general information purposes only and do not represent an offer or contract or part of one. Carter Jonas or anyone in their employment has made every attempt to ensure that the particulars and other information provided are as accurate as possible and they are not intended to amount to advice on which you should rely as being factually accurate. Full information which may be relevant to your decision regarding the property can be found on the property listing on carterjonas.co.uk or a separately available material information sheet, and we would advise you to confirm the details of any material information prior to any offer being submitted. You should not assume that the property has all necessary planning, building regulations or other consents and Carter Jonas has not tested any services, facilities, or equipment. Any measurements and distances given are approximate only. Where Carter Jonas has been provided with a floorplan by a third party, we cannot guarantee that the floorplan has been measured in accordance with IPMS. Purchasers or prospective tenants must satisfy themselves of all of the aforementioned by independent inspection or otherwise. Our images only represent part of the property as it appeared at the time they were taken and do not represent the furnishings included; these are confirmed in a separate inventory. If you require further information, please contact us. *Administration fees may apply depending on tenancy type. Please contact your local branch for this information.