



CHAPTER STREET, LONDON, SW1P

£715.38 per week*

Carter Jonas

FLAT 3, CHAPTER STREET, LONDON, SW1P

- Two double bedrooms
- Large reception room
- Excellent storage
- Lift
- Wooden flooring throughout
- Eat-in Kitchen
- Two balconies
- Furnished

THE PROPERTY

This beautifully presented first-floor apartment, with lift access, offers generous living space and an abundance of natural light throughout. The property features two spacious double bedrooms, each with fitted wardrobes, and a well-proportioned bathroom with contemporary tiled flooring.

A bright and inviting reception room opens onto a private balcony, perfect for relaxing or entertaining, while the separate fully fitted eat-in kitchen also benefits from its own balcony, adding to the sense of space and versatility. The apartment is finished in a neutral décor with elegant wooden flooring throughout, creating a stylish yet homely feel.

Ideally located in the sought-after area of Pimlico, the property is moments from an array of local shops, cafés, and amenities. The open green spaces of Vincent Square are within easy reach, while excellent transport connections are provided by Pimlico Underground Station (Victoria Line), ensuring swift access across London.

AST

The deposit will be £3,576.75 at a rental value of £715.38pw (asking price)

Holding deposit = 1 weeks rent of £715.38

Deposit is 5 weeks rent (£715.38pw = £3,576.75 deposit)

A bright and spacious two double bedroom apartment presented in excellent condition throughout and situated on the 1st floor of a modern block within close proximity of Victoria and Pimlico. EPC rating C.



ADDITIONAL INFORMATION

Offers Available for a minimum term of 12 months longer terms will be considered

Viewing Strictly by appointment

Local Authority Westminster City Council - Council Tax Band E

Council Tax Band E

Local Authority: Westminster City Council

Heating: Electric (on meter)

Parking: Garage & Residents Parking

Broadband: ADSL - Up to 21Mbps available

Energy Efficiency Rating		Current	Potential
Very energy efficient - lower running costs			
(92-100)	A		
(81-91)	B		
(69-80)	C	76	78
(55-68)	D		
(39-54)	E		
(21-38)	F		
(1-20)	G		
Not energy efficient - higher running costs			
England, Scotland & Wales		EU Directive 2002/91/EC	

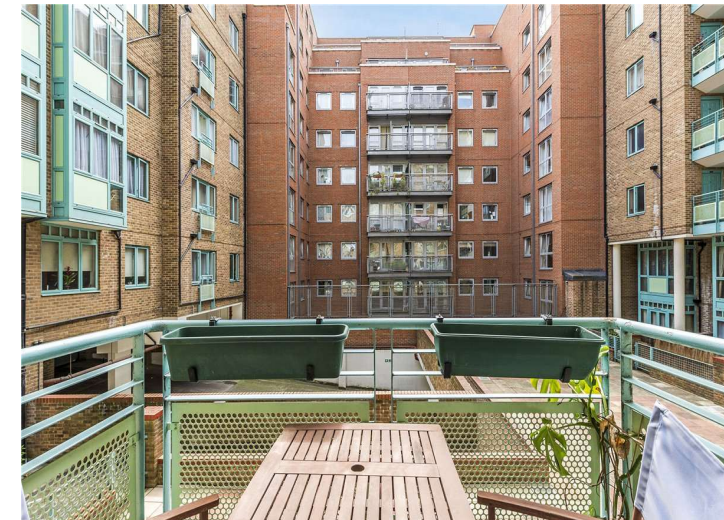

Chapter Street, SW1P



Approximate Gross Internal Area = 74.8 sq m / 805 sq ft

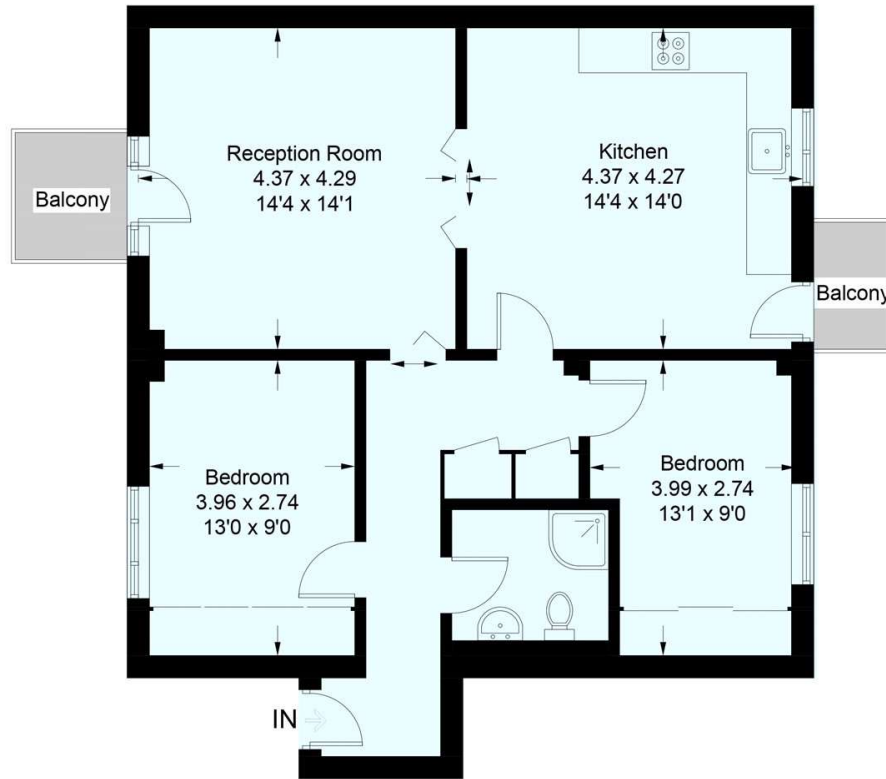

First Floor

This plan is for layout guidance only. Not drawn to scale unless stated. Windows and door openings are approximate. Whilst every care is taken in the preparation of this plan, please check all dimensions, shapes and compass bearings before making any decisions reliant upon them. (ID342107)

T: 020 7493 0676

18 Davies Street, Mayfair, London, W1K 3DS

E: mayfair@carterjonas.co.uk



Exclusive UK affiliate of

CHRISTIE'S
INTERNATIONAL REAL ESTATE

Classification L2 - Business Data



IMPORTANT INFORMATION

These particulars are for general information purposes only and do not represent an offer or contract or part of one. Carter Jonas or anyone in their employment has made every attempt to ensure that the particulars and other information provided are as accurate as possible and they are not intended to amount to advice on which you should rely as being factually accurate. Full information which may be relevant to your decision regarding the property can be found on the property listing on carterjonas.co.uk or a separately available material information sheet, and we would advise you to confirm the details of any material information prior to any offer being submitted. You should not assume that the property has all necessary planning, building regulations or other consents and Carter Jonas has not tested any services, facilities, or equipment. Any measurements and distances given are approximate only. Where Carter Jonas has been provided with a floorplan by a third party, we cannot guarantee that the floorplan has been measured in accordance with IPMS. Purchasers or prospective tenants must satisfy themselves of all of the aforementioned by independent inspection or otherwise. Our images only represent part of the property as it appeared at the time they were taken and do not represent the furnishings included; these are confirmed in a separate inventory. If you require further information, please contact us. *Administration fees may apply depending on tenancy type. Please contact your local branch for this information.