



NOTTINGHAM STREET, LONDON, W1U
£530.77 per week*

Carter Jonas

BASEMENT FLAT, NOTTINGHAM STREET, LONDON, W1U 5EF

- Open Plan Kitchen and reception room
- Fully Fitted Kitchen
- Wooden floors throughout
- One Double Bedroom
- Modern Bathroom
- Available on a furnished basis

THE PROPERTY

Comprising of an open plan reception room with fitted kitchen, double bedroom to the rear with en suite bathroom. Located on the lower ground floor of a period property.

Available for long term rental on a furnished basis.

£2,300pm plus £200 for all services including council tax, water, electric, heating, hot water, broadband & council tax (excluding TV licence)

Holding deposit is 1 week's rent = £530.77 (at asking price)

Security deposit is 5 weeks rent = £2,653 (at asking price £530.77pw)

Minimum term 12 months

Council Tax Band F

For the latest information on broadband and mobile coverage, please visit [/checker.ofcom](https://www.ofcom.gov.uk/broadbandchecker/) for the most up-to-date details.

Nottingham Street is a charming, tree-lined street in the heart of Marylebone. Known for its picturesque Georgian architecture and peaceful atmosphere, it is home to a mix of residential properties and small businesses, including cafes, boutiques, and art galleries. The street is within easy walking distance of popular attractions like Regent's Park and Oxford Street. Baker Street station is conveniently located approximately 0.4 miles and Bond Street station approximately 0.6 miles.

One bedroom apartment which is conveniently located just off Marylebone High Street.



ADDITIONAL INFORMATION

Offers	Available for a minimum term of 12 months longer terms will be considered
Viewing	Strictly by appointment
Local Authority	Westminster City Council - Council Tax Band F

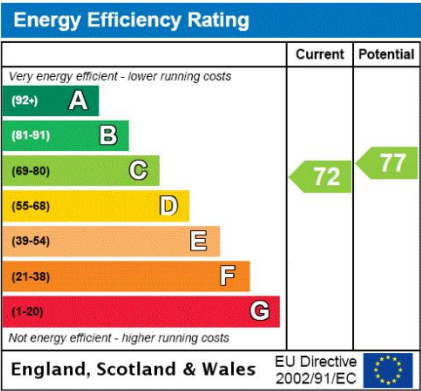

Nottingham Street, W1U

Approx. Gross Internal Area 346 Sq Ft - 32.14 Sq M

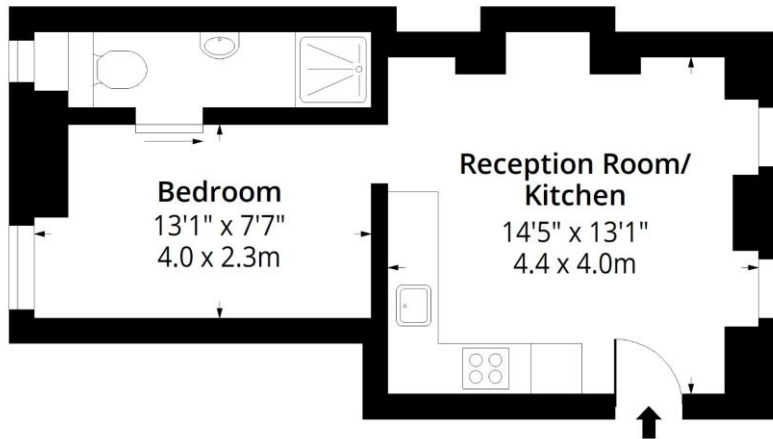
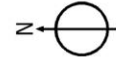

Lower Ground Floor

Floor Area 346 Sq Ft - 32.14 Sq M



Measured according to RICS IPMS2. Floor plan is for illustrative purposes only and is not to scale. Every attempt has been made to ensure the accuracy of the floor plan shown, however all measurements, fixtures, fittings and data shown are an approximate interpretation for illustrative purposes only. 1 sq m = 10.76 sq feet.

lpaplus.com

Date: 16/5/2023

T: 020 7486 8866

37 New Cavendish Street, London, W1G 9TL

E: marylebone.lettings@carterjonas.co.uk

A member of



Exclusive UK affiliate of

CHRISTIE'S
INTERNATIONAL REAL ESTATE

Classification L2 - Business Data



IMPORTANT INFORMATION

These particulars are for general information purposes only and do not represent an offer or contract or part of one. Carter Jonas or anyone in their employment has made every attempt to ensure that the particulars and other information provided are as accurate as possible and they are not intended to amount to advice on which you should rely as being factually accurate. Full information which may be relevant to your decision regarding the property can be found on the property listing on carterjonas.co.uk or a separately available material information sheet, and we would advise you to confirm the details of any material information prior to any offer being submitted. You should not assume that the property has all necessary planning, building regulations or other consents and Carter Jonas has not tested any services, facilities, or equipment. Any measurements and distances given are approximate only. Where Carter Jonas has been provided with a floorplan by a third party, we cannot guarantee that the floorplan has been measured in accordance with IPMS. Purchasers or prospective tenants must satisfy themselves of all of the aforementioned by independent inspection or otherwise. Our images only represent part of the property as it appeared at the time they were taken and do not represent the furnishings included; these are confirmed in a separate inventory. If you require further information, please contact us. *Administration fees may apply depending on tenancy type. Please contact your local branch for this information.