



DUKE STREET, MARYLEBONE, W1U
£807 per week*

Carter Jonas

FLAT 2, SECOND FLOOR, DUKE STREET, MARYLEBONE, LONDON, W1U 3EB

- Professionally managed by The Portman Estate.
- Second-floor one-bedroom apartment
- Bright and spacious reception room with large windows
- Attractive feature fireplace adding character
- Separate modern kitchen with integrated appliances and good storage
- Generous double bedroom with built-in storage
- Ideal for first-time buyers, professionals, or investors
- Practical layout in a convenient location
- Unfurnished basis, or furnished (at separate cost)

THE PROPERTY

Bright and well-proportioned one-bedroom apartment set on the second floor, offering approximately 500 sq ft of comfortable living space. The property features a spacious reception room with large windows and a charming feature fireplace, creating a welcoming and airy feel. A separate modern kitchen is neatly designed with ample storage and integrated appliances.

The generous double bedroom benefits from built-in storage, while the bathroom is well-appointed and conveniently located off the hallway.

Available for long term rental on an unfurnished basis, or furnished via separate negotiation.

The property is professionally managed by the Portman Estate.

Duke Street in London is a calm, well-kept street lined with classic buildings, small shops, and cafés, offering a quieter feel while still being close to busy central areas. It sits just off Oxford Street, making it convenient for shopping and city life without the heavy crowds. The nearest train stations are Bond Street Station, which is only a short walk away, along with Marble Arch Station and Oxford Circus Station, all providing easy access to the rest of London.

The Portman Estate's 110 acres of land within Marylebone, London W1, has a rich heritage dating back to the 16th century and is the

Charming one bedroom apartment with impressive views & access to residents only Manchester Square.



DUKE STREET

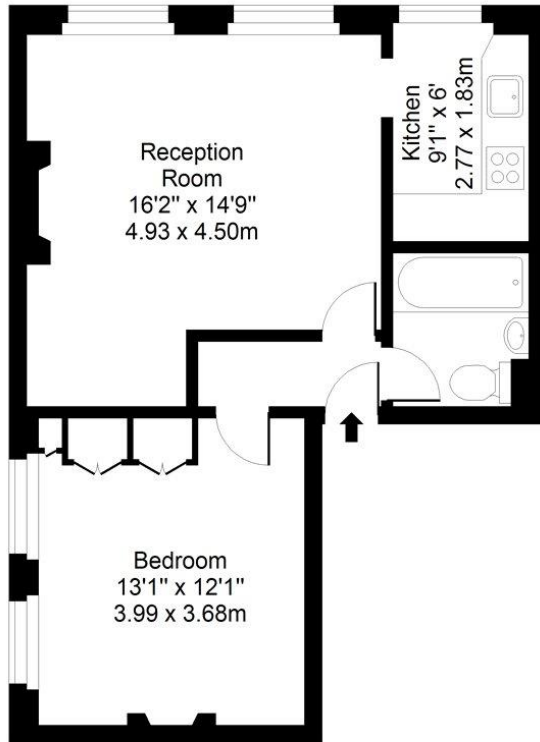
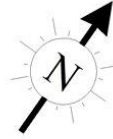

Second Floor

Approx. Gross Internal Area 500 Sq Ft - 46.45 Sq M

For Illustrative Purposes Only - Not To Scale

www.lpaplus.com

T: 020 7486 8866

37 New Cavendish Street, London, W1G 9TL

E: marylebone.lettings@carterjonas.co.uk

A member of



Exclusive UK affiliate of

CHRISTIE'S
INTERNATIONAL REAL ESTATE

Classification L2 - Business Data



IMPORTANT INFORMATION

These particulars are for general information purposes only and do not represent an offer or contract or part of one. Carter Jonas or anyone in their employment has made every attempt to ensure that the particulars and other information provided are as accurate as possible and they are not intended to amount to advice on which you should rely as being factually accurate. Full information which may be relevant to your decision regarding the property can be found on the property listing on carterjonas.co.uk or a separately available material information sheet, and we would advise you to confirm the details of any material information prior to any offer being submitted. You should not assume that the property has all necessary planning, building regulations or other consents and Carter Jonas has not tested any services, facilities, or equipment. Any measurements and distances given are approximate only. Where Carter Jonas has been provided with a floorplan by a third party, we cannot guarantee that the floorplan has been measured in accordance with IPMS. Purchasers or prospective tenants must satisfy themselves of all of the aforementioned by independent inspection or otherwise. Our images only represent part of the property as it appeared at the time they were taken and do not represent the furnishings included, these are confirmed in a separate inventory. If you require further information, please contact us. *Administration fees may apply depending on tenancy type. Please contact your local branch for this information.