



**GREAT CLARENDON STREET, OXFORD, OX2**

£2,250 per month\*

**Carter Jonas**

---

# GREAT CLARENDON STREET, OXFORD, OXFORDSHIRE, OX2 6AT

A recently renovated, light and modern terraced Victorian house situated in desirable Jericho.

- 2 bedrooms
- 1 bathroom
- open plan reception room
- galley style kitchen
- Victorian terraced house
- unfurnished
- professionally managed

## THE PROPERTY

Accommodation consists, entrance hall, living/dining room, modern kitchen with door leading to the garden, ground floor bathroom with a shower over the bath. Two bedrooms both with built-in wardrobes. Enclosed garden to the rear and the property is eligible for on-street parking permits.

Jericho is a vibrant and lively place to live and highly desirable with its close proximity to the city centre.

Available early May. Unfurnished.

Council tax band D - Please see Oxford City website for current charges.

EPC: C

Flood Risk: Very low

Holding deposit = 1 weeks rent £519

Deposit = 5 weeks rent = £2596

Mains gas, electricity, water and drainage.

Internet & Mobile: Further information on availability and speeds can be found at [checker.ofcom.org.uk](http://checker.ofcom.org.uk)



---

## ADDITIONAL INFORMATION

Offers Available for a minimum term of 12 months longer terms will be considered

---

Viewing Strictly by appointment

---

Local Authority Oxford City Council - Council Tax Band D

---



**Approximate Gross Internal Area 587 sq ft - 54 sq m**

Ground Floor Area 346 sq ft – 32 sq m

First Floor Area 241 sq ft – 22 sq m

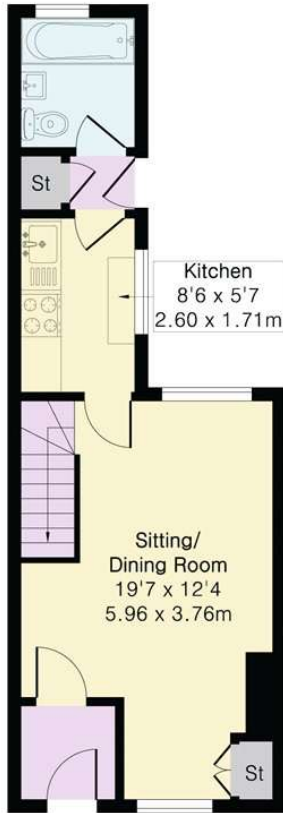

Ground Floor

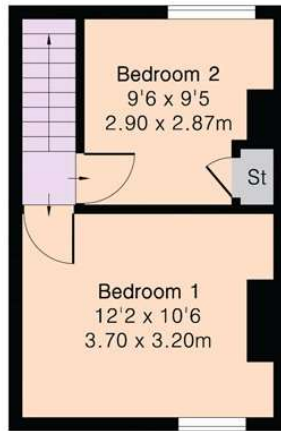

First Floor



Score	Energy rating	Current	Potential
92+	A		
81-91	B		
69-80	C		
55-68	D	71 C	89 B
39-54	E		
21-38	F		
1-20	G		

**T: 01865 511444**

Mayfield House, 256 Banbury Road, Oxford, Oxfordshire, OX2 7DE

E: [oxford.lettings@carterjonas.co.uk](mailto:oxford.lettings@carterjonas.co.uk)



*Exclusive UK affiliate of*

**CHRISTIE'S**  
INTERNATIONAL REAL ESTATE

Classification L2 - Business Data

**IMPORTANT INFORMATION**

These particulars are for general information purposes only and do not represent an offer or contract or part of one. Carter Jonas or anyone in their employment has made every attempt to ensure that the particulars and other information provided are as accurate as possible and they are not intended to amount to advice on which you should rely as being factually accurate. Full information which may be relevant to your decision regarding the property can be found on the property listing on [carterjonas.co.uk](http://carterjonas.co.uk) or a separately available material information sheet, and we would advise you to confirm the details of any material information prior to any offer being submitted. You should not assume that the property has all necessary planning, building regulations or other consents and Carter Jonas has not tested any services, facilities, or equipment. Any measurements and distances given are approximate only. Where Carter Jonas has been provided with a floorplan by a third party, we cannot guarantee that the floorplan has been measured in accordance with IPMS. Purchasers or prospective tenants must satisfy themselves of all of the aforementioned by independent inspection or otherwise. Our images only represent part of the property as it appeared at the time they were taken and do not represent the furnishings included; these are confirmed in a separate inventory. If you require further information, please contact us. \*Administration fees may apply depending on tenancy type. Please contact your local branch for this information.