



PARADISE STREET, OXFORD, OX1

£2,100 per month*

Carter Jonas

12 SWAN COURT, PARADISE STREET, OXFORD, OXFORDSHIRE, OX1 1JB

- Hallway
- Two double bedrooms
- Kitchen
- Open plan/living room/dining area
- Family bathroom
- Allocated parking
- Communal gardens

THE PROPERTY

This well-presented two-bedroom apartment is situated on the sought-after Paradise Street in the heart of Oxford, offering modern city-centre living.

The property comprises two spacious bedrooms, an open-plan living/dining area, a contemporary fitted kitchen with integrated appliances, and a modern bathroom with shower over bath. Further benefits include secure entry and the potential for an allocated parking space (subject to confirmation). The property also offers a riverside view, which is particularly beautiful during the warmer months and provides a lovely spot to sit and relax in the evening.

Swan Court is excellently located within walking distance of Oxford train station, Westgate Shopping Centre, and a wide range of amenities, with superb access to Oxford's historic colleges, restaurants, and transport links to London and beyond.

The property is available for a minimum tenancy term of 12 months.

Available late May on an furnished basis.

Zone 1 flood risk - very low.

Internet & Mobile: Further information on availability and speeds can be found at checker.ofcom.org.uk

Council Tax Band E / EPC Rating D

This well-presented two-bedroom apartment is situated on the sought-after Paradise Street in the heart of Oxford, offering modern city-centre living.



Holding deposit = 1 weeks rent £484

Deposit = 5 weeks rent @ £2100pcm = £2423

OUTSIDE

ADDITIONAL INFORMATION

Offers Available for a minimum term of 12 months longer terms will be considered

Viewing Strictly by appointment

Local Authority Oxford City Council - Council Tax Band E

Directions



Approximate Gross Internal Area 576 sq ft - 54 sq m

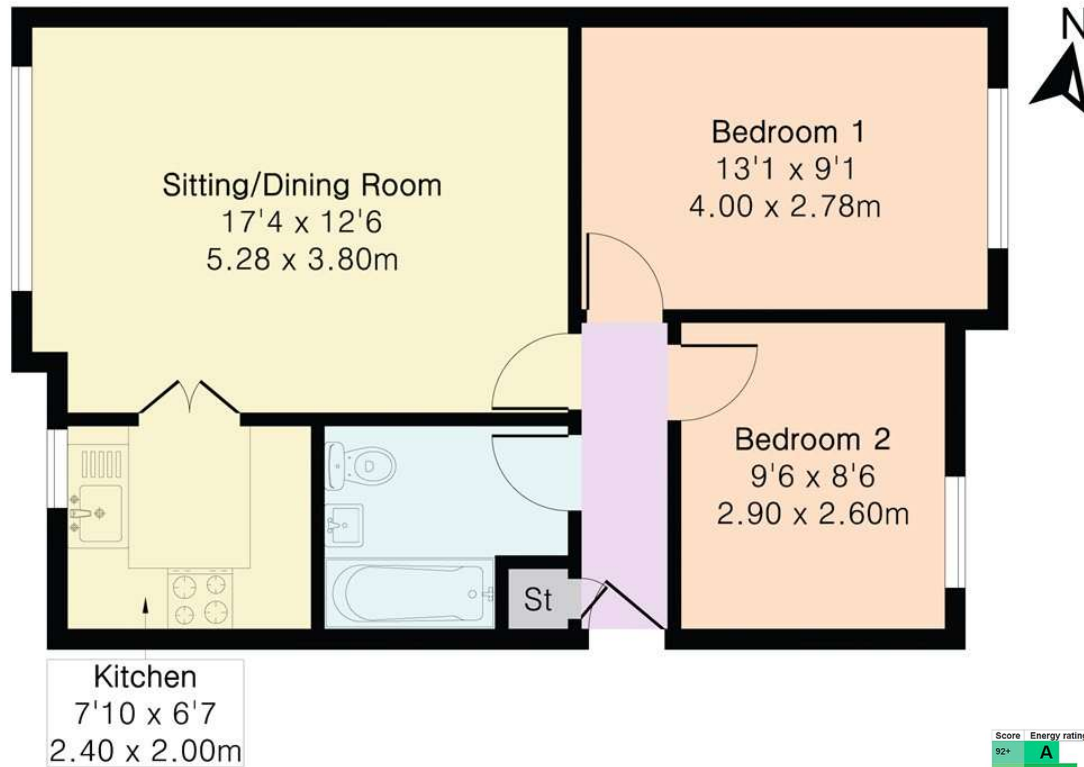

Second Floor

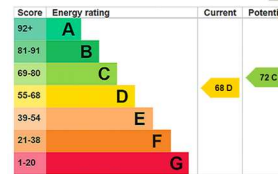

Floor plan produced in accordance with RICS Property Measurement 2nd Edition. Although Pink Plan Ltd ensures the highest level of accuracy, measurements of doors, windows and rooms are approximate and no responsibility is taken for error, omission or misstatement. These plans are for representation purposes only and no guarantee is given on the total square footage of the property within this plan. The figure icon is for initial guidance only and should not be relied on as a basis of valuation.

Carter Jonas

T: 01865 511444

Mayfield House, 256 Banbury Road, Oxford, Oxfordshire, OX2 7DE

E: oxford.lettings@carterjonas.co.uk



Exclusive UK affiliate of

CHRISTIE'S
INTERNATIONAL REAL ESTATE

Classification L2 - Business Data

IMPORTANT INFORMATION

These particulars are for general information purposes only and do not represent an offer or contract or part of one. Carter Jonas or anyone in their employment has made every attempt to ensure that the particulars and other information provided are as accurate as possible and they are not intended to amount to advice on which you should rely as being factually accurate. Full information which may be relevant to your decision regarding the property can be found on the property listing on carterjonas.co.uk or a separately available material information sheet, and we would advise you to confirm the details of any material information prior to any offer being submitted. You should not assume that the property has all necessary planning, building regulations or other consents and Carter Jonas has not tested any services, facilities, or equipment. Any measurements and distances given are approximate only. Where Carter Jonas has been provided with a floorplan by a third party, we cannot guarantee that the floorplan has been measured in accordance with IPMS. Purchasers or prospective tenants must satisfy themselves of all of the aforementioned by independent inspection or otherwise. Our images only represent part of the property as it appeared at the time they were taken and do not represent the furnishings included; these are confirmed in a separate inventory. If you require further information, please contact us. *Administration fees may apply depending on tenancy type. Please contact your local branch for this information.