



WILDCROFT ROAD, LONDON, SW15
£3,600 per month*

Carter Jonas

WILDCROFT MANOR, LONDON, SW15

- Four bedrooms
- Situated near Putney Heath
- Two bathrooms
- Lift access
- Second floor apartment
- 1650 square feet

THE PROPERTY

Nestled on the second floor of the prestigious Wildcroft Manor, this generously sized four-bedroom apartment offers an abundance of natural light and tranquillity. Built in the 1930s on the historic grounds once owned by Sir George Newnes, Wildcroft Manor is highly sought after for its serene ambiance and stunning architecture.

The apartment features neutral decor throughout, ensuring a versatile backdrop for any style. With two well-appointed bathrooms and a lift servicing all floors, convenience and comfort are at the forefront. Residents will appreciate the inclusion of heating and hot water in the rent, adding to the appeal of this remarkable home.

Additionally, the property provides access to meticulously maintained communal grounds, perfect for leisurely strolls or enjoying a moment of peace. Set in the idyllic Putney Heath, an area renowned as the premier destination for suburban mansion flats, this residence offers both a prime location and unparalleled living experience.

A spacious apartment with four bedrooms, situated on the second floor (with a lift) of the sought after Wildcroft Manor.



ADDITIONAL INFORMATION

Offers	Available for a minimum term of 12 months longer terms will be considered
Viewing	Strictly by appointment
Local Authority	London Borough of Wandsworth - Council Tax Band G

EPC Rating: C

Cost of heating and water included in the rent.

Available for a minimum term of 12 months.

Information on internet and mobile availability and speeds
can be found on Ofcom's website.

At a rent of £3,600 per month

Holding deposit of 1 weeks rent: £830.77

Security deposit of 5 weeks rent: £4,153.85



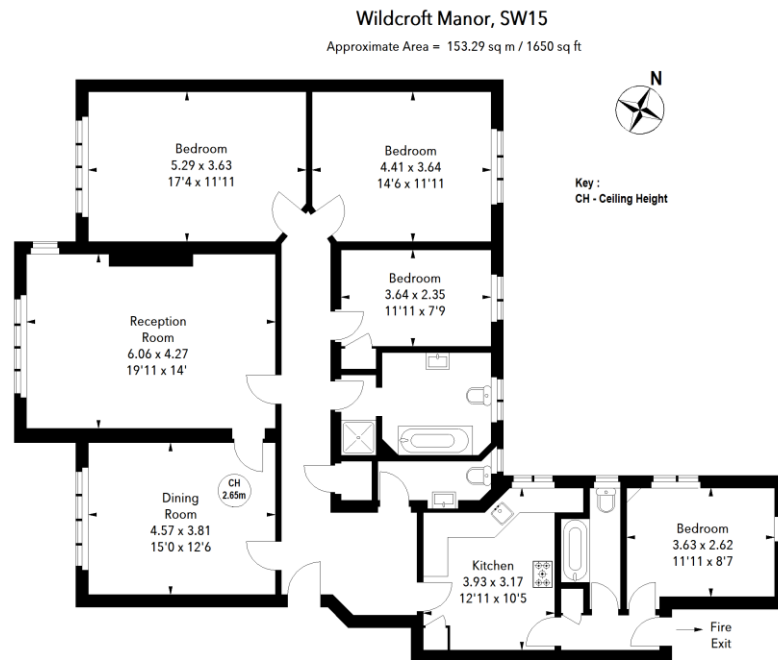

The floor plan is not to scale and measurements and areas shown are approximate and therefore should be used for illustrative purposes only. The plan has been prepared in accordance with the RICS code of Measuring Practice and whilst we have confidence in the information produced, it must not be relied on. If there is any aspect of particular importance, you should carry out or commission your own inspection of the property.



T: 020 7518 3260

24 Replingham Road, London, SW18 5LR

E: sou.res.lets@carterjonas.co.uk

A member of



Exclusive UK affiliate of

CHRISTIE'S
INTERNATIONAL REAL ESTATE

Classification L2 - Business Data

IMPORTANT INFORMATION

These particulars are for general information purposes only and do not represent an offer or contract or part of one. Carter Jonas or anyone in their employment has made every attempt to ensure that the particulars and other information provided are as accurate as possible and they are not intended to amount to advice on which you should rely as being factually accurate. Full information which may be relevant to your decision regarding the property can be found on the property listing on carterjonas.co.uk or a separately available material information sheet, and we would advise you to confirm the details of any material information prior to any offer being submitted. You should not assume that the property has all necessary planning, building regulations or other consents and Carter Jonas has been tested any services, facilities, or equipment. Any measurements and distances given are approximate only. Where Carter Jonas has been provided with a floorplan by a third party, we cannot guarantee that the floorplan has been measured in accordance with IPMS. Purchasers or prospective tenants must satisfy themselves of all of the aforementioned by independent inspection or otherwise. Our images only represent part of the property as it appeared at the time they were taken and do not represent the furnishings included; these are confirmed in a separate inventory. If you require further information, please contact us. *Administration fees may apply depending on tenancy type. Please contact your local branch for this information.